

KUHN HUARD

ORIGINE

ADAPTABLE

CARBURE

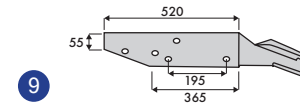
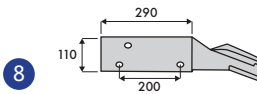
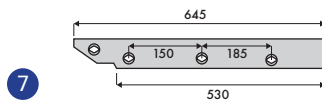
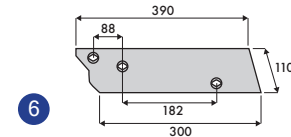
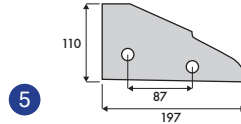
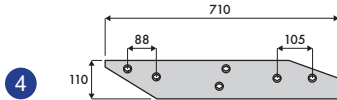
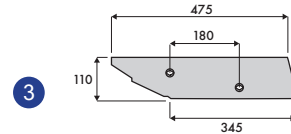
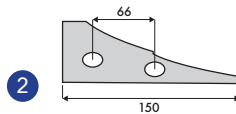
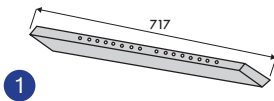

N°	Désignation	Origine	Prix € HT	Adaptable	Prix € HT	Carbure	Prix € HT	Boulon
BARRE								
1	Barre carrée 28 L 717	HD460022	42,56	ADHD460022	30,69			
-	Barre carrée 32 D L 725	HD460026	70,86					
-	Barre carrée 32 G L 725	HD460027	70,86					
C/SEP CORPS H4								
2	Nez c/sep D	HD223120	18,19	ADHD223120	8,54	ABCSH0120D	51,71	BA36512X39
2	Nez c/sep G	HD223121	18,19	ADHD223121	8,54	ABCSH0120G	51,71	BA36512X39
C/SEP CORPS HB/HC								
-	Nez c/sep D	HD761106	18,19			ABCSH0106D	46,3	BA36512X39
-	Nez c/sep G	HD761107	18,19			ABCSH0106G	46,3	BA36512X39
C/SEP CORPS BL								
3	C/sep avant court D	HD278070	37,25					BA35512X35
3	C/sep avant court G	HD278071	37,25					BA35512X35
4	C/sep arrière long D	HD278072	45,86					BA35512X35
4	C/sep arrière long G	HD278073	45,86					BA35512X35
5	Nez c/sep D	HD279142	19,03	ADHD279142	20,43			BA36512X39
5	Nez c/sep G	HD279143	19,03	ADHD279143	20,43			BA36512X39
C/SEP CORPS CLASSIQUE								
6	C/sep avant court D	HD278074	29,21	ADHD278074/5	11,88			BA35512X35
6	C/sep avant court G	HD278075	29,21	ADHD278074/5	11,88			BA35512X35
-	C/sep arrière long D	HD278076	41,43	ADHD278076/7	17,18			BA35512X35
-	C/sep arrière long G	HD278077	41,43	ADHD278076/7	17,18			BA35512X35
7	C/sep long D	HD279130	39,81					BA35512X35
7	C/sep long G	HD279131	39,81					BA35512X35
-	Nez c/sep D	HD279138	18,19	ADHD279138	4,27	ABCSH0138D	46,3	BA36512X39
-	Nez c/sep G	HD279139	18,19	ADHD279139	4,27	ABCSH0138G	46,3	BA36512X39
C/SEP CORPS A BARRE								
8	C/sep e28 avant D	HD279006	79,08	ADHD279006	72,96			BA35512X35
8	C/sep e28 avant G	HD279007	79,08	ADHD279007	72,96			BA35512X35
9	C/sep e28 arrière D			ADHD279008	78,6			BA35512X35
9	C/sep e28 arrière G			ADHD279009	78,6			BA35512X35
8	C/sep e28 avant avec coutre D	HD549006	92,89	ADHD549006	81,64			BA35512X35
8	C/sep e28 avant avec coutre G	HD549007	92,89	ADHD549007	81,64			BA35512X35
9	C/sep e28 arrière avec coutre D	HD549008	100,1	ADHD549008	95,4			BA35512X35
9	C/sep e28 arrière avec coutre G	HD549009	100,1	ADHD549009	95,4			BA35512X35